

1:3

technical parameter  
 Rated current: Power 7A<sub>Max</sub>/ Brake 5A<sub>Max</sub>  
 Rated voltage: 200VAC  
 Insulation withstand voltage: 1500VAC  
 Insulation impedance: 1000MQ<sub>Min</sub>.at500VDC  
 Working temperature: -20 °C to 105 °C  
 Protection level: IP67

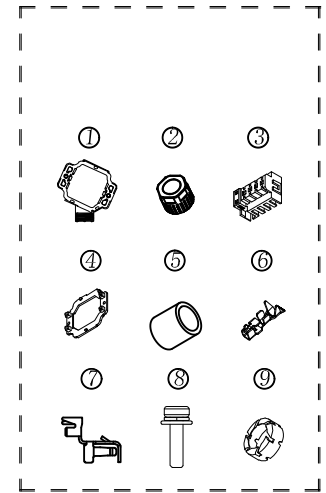

10	Gasket	stainless steel	2
9	Clamp	PA66+30GF UL94V-0 Black	1
8	Screw	SPCCM2*12 Black	2
7	Contact	C5191-H,gold-plated	4
6	Contact	C5191-H,gold-plated	2
5	Seal	Rubber,TPPA Black	1
4	Seal	Rubber,TPPA Black	1
3	Insert	PA66+30GF UL94V-0 Black	1
2	Nut	PA66+30GF UL94V-0 Black	1
1	Body	PA66+30GF UL94V-0 Black	1
No.	PART NAME	DESCRIPTION	Q'TY

1

2

3

4

5

6