

SPECIFICATION

Current Rating: 1 A Max
 Dielectric Withstanding Voltage:
 500V AC For 1 Minute
 Contact Resistance: 30 Milliohms Max.
 Insulation Resistance: 1000 Megohms Min
 At DC 500V
 Temperature Range: -55°C ~ +105°C
 RoHS Compliant

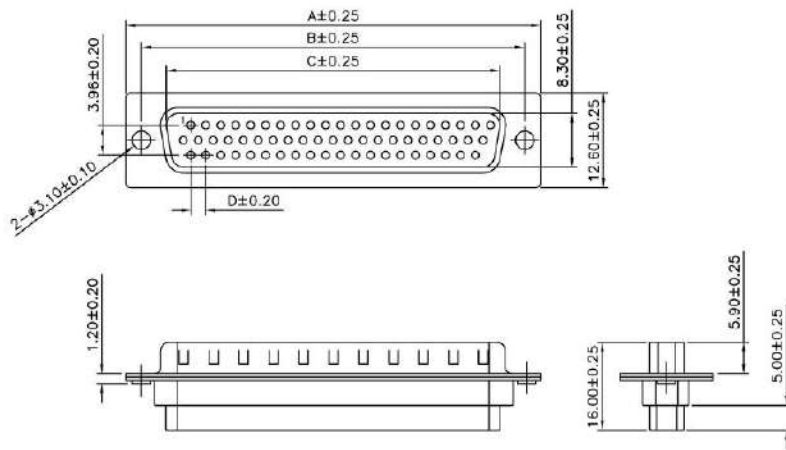

Pin	A	B	C	D
15	30.80	25.00	16.92	2.29
26	39.20	33.32	25.25	2.29
44	53.05	47.04	38.96	2.29
62	69.40	63.50	55.42	2.41

No.	Part Name	Q'ty	Material	Remarks & Thickness	Finish
1	Housing	2	P.B.T	UL 94V-0	Black
2	Contact	15~62	Brass	T=0.20mm	Gold Flash
3	Front-Shell	1	Cold Rolled Steel	T=0.40mm	Tin Plated
4	Back-Shell	1	Cold Rolled Steel	T=0.40mm	Tin Plated



CATEGORY		APPROVED BY		UNLESS OTHERWISE SPECIFIED TOLERANCES ARE .X ±0.3 .XX ±0.20 .XXX ±0.100 ANG. ±1°				
PART No. 70 05 XX HD		CHECKED BY						
DRAWING No.		DRAWING BY						
SCALE	NONE	REV.	BO		UNIT	mm	NO. REV.	NEW RELEASE
						REVISIONS	CHK	DATE