

SPECIFICATION

Current Rating:5A
 Withstanding Voltage:1000V(One Minute)
 Insulation Resistance:1000 Megaohms Min.At 500V DC
 Operating Temperature:-50°C~+105°C
 Shell:Steel Material,Front Nickel After Tin
 Insulator:P.B.T+30% Glass Fiber(UL94V-0)
 Contact:Brass,Gold Plating Over Nickel
 RoHS Compliant

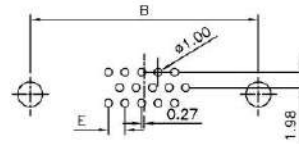

PCB Layout

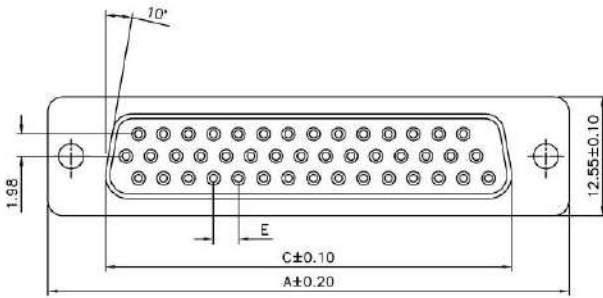
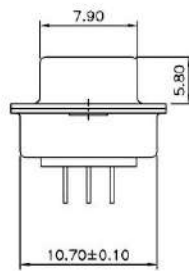
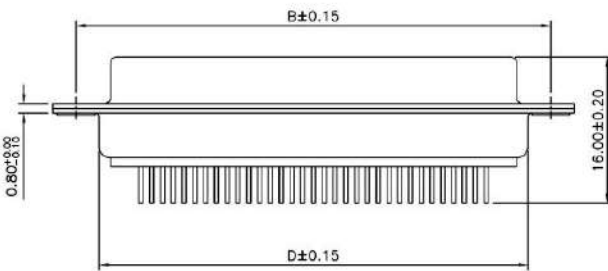

Pin	A	B	C	D	E
15	30.80	25.00	16.30	19.20	2.29
26	39.20	33.30	24.60	27.70	2.29
44	53.05	47.04	38.38	41.10	2.29
62	69.40	63.50	54.80	57.30	2.41



CATEGORY	APPROVED BY	UNLESS OTHERWISE SPECIFIED TOLERANCES ARE .X ±0.25 .X* ±3* .XX ±0.15 .XX* ±1* .XXX ±0.05 .XXX* ±0.5*
PART No. 70 04 XX HD	CHECKED BY	
DRAWING No.	DRAWING BY	
SCALE NONE	REV. A0	
UNIT mm		

NO. REV.	REVISIONS	DATE
A0	NEW RELEASE	06/17/2008