

SPECIFICATION

Current Rating:5Amps
 Withstanding Voltage:1000V(One Minute)
 Insulation Resistance:1000Megohms Min At 500V DC
 Operating Temperature:-50°C~+105°C
 Insulator:PBT+30% Glass Fiber(UL94V-0)
 Contact:Brass,Gold Plating Over Nickel
 Shell:Steel,Front Nickel After Tin Plated
 RoHS Compliant

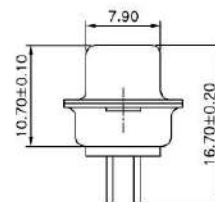

Position	A	B	C	D
9	30.80	25.00	16.30	19.20
15	39.20	33.30	24.60	27.70
25	53.05	47.04	38.38	41.10
37	69.40	63.50	54.80	57.30

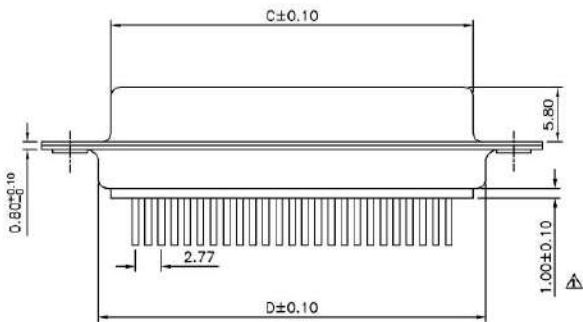

CATEGORY	APPROVED BY	UNLESS OTHERWISE SPECIFIED TOLERANCES ARE .X ±0.25 .X' ±3" .XX ±0.15 .XX' ±1" .XXX ±0.05 .XXX' ±0.5"
PART No. 70 04 XX	CHECKED BY	
DRAWING No.	DRAWING BY	
SCALE NONE	REV. A2	
UNIT mm		

NO.	REV.	REVISIONS	DATE
		Add Color Table	08/20/2008
		Add Dim 1.00±0.10	08/14/2008
		NEW RELEASE	09/19/2007