

**SPECIFICATION**

Current:1.0A Max.  
 Voltage:30V Max.  
 Withstanding Voltage:750V AC  
 Contact Resistance:30 Milliohms Max.  
 Insulation Resistance:1000 Megaohms Min.  
 Temperature Range:-55°C ~ +85°C  
 Mating Force:45N Max.  
 Withdrawal Force:7N Min.  
 Durability:500 Cycles Min.  
 Contacts:Brass,Gold Flash On Contact Area,Tin Plated  
 On Solder Tail,Underplated Nickel Over All  
 Insulator:PBT+30%G.F UL94V-0  
 Shell:Brass,Nickel Plated Over All  
 RoHS Compliant

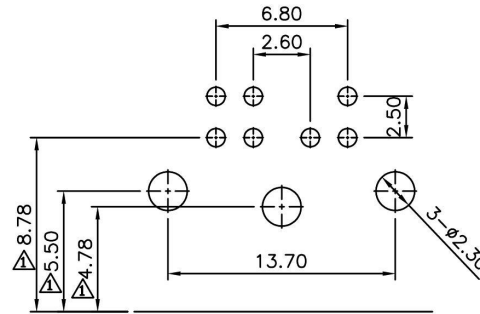

Recommended P.C.B Pattern Layout

**Spectra Connectronics Pvt. Ltd.**  
 HOUSE OF CONNECTORS™

CATEGORY		APPROVED BY		UNLESS OTHERWISE SPECIFIED TOLERANCES ARE .X ±0.38 .X* ±2* .XX ±0.25 .XX* ±1* .XXX ±0.13 .XXX* ±0.5*
PART No. 5103 07		CHECKED BY		
DRAWING No.		DRAWING BY		
SCALE	NONE	REV.	A1	
UNIT mm				

NO.	REV.	REVISIONS	CHK	DATE
A1		Modify Data	HZF	08/04/2009
A0		NEW RELEASE	HZF	01/03/2009