

**SPECIFICATIONS**

Rating:100V AC 1A Max Or 12V DC 2A Max  
 Insulation Resistance:50Megohms Min At 500V DC  
 Dielectric Strength:500V AC/1 Minute  
 Cover:EVA+PE-LL  
 Shell:ABS(PA-757)  
 Metal Shield:Brass Nickel Plated  
 Housing:PA6+GF  
 Contact:Brass Silver Plated  
 RoHS Compliant

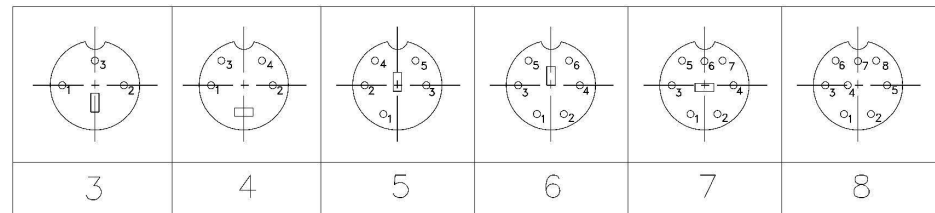
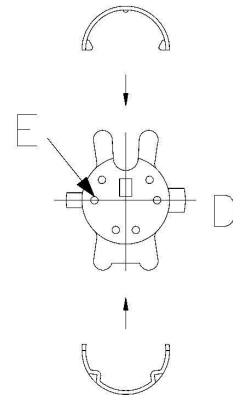
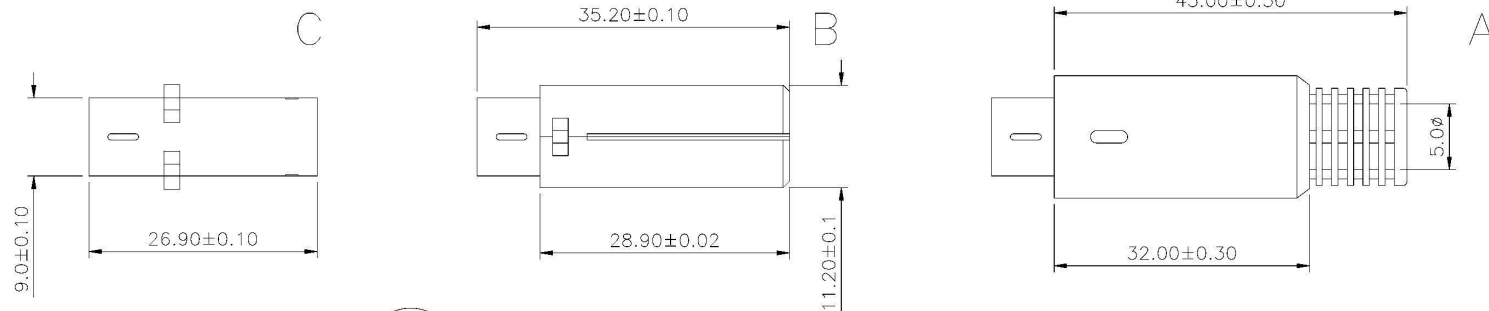

**Spectra Connectronics Pvt. Ltd.**  
 HOUSE OF CONNECTORS™

CATEGORY		APPROVED BY		UNLESS OTHERWISE SPECIFIED TOLERANCES ARE .X ±0.38 .XX ±0.25 ANG.				
PART No. 51 01 XX		CHECKED BY						
DRAWING No.		DRAWING BY						
SCALE	NONE	REV.	B0	UNIT mm	⊕	⏏	BO NEW RELEASE	EMILY 09/17/2008
							NO.REV. REVISIONS	CHK DATE