

Recommended P.C.B. Layout

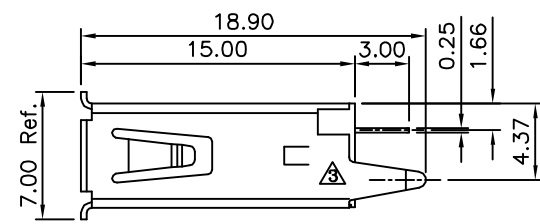

△

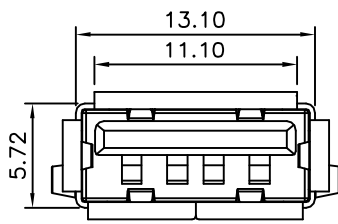
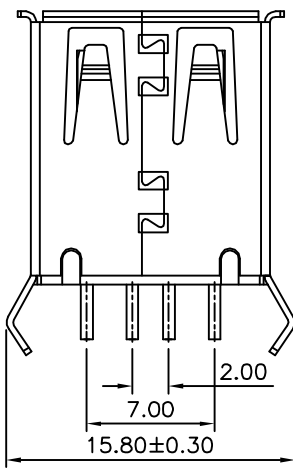

△ SPECIFICATION
 Current:1.5A(Current=3A Max.,When Voltage=5V)
 Voltage:30V Max.
 Withstanding Voltage:500V AC For One Minute
 Contact Resistance:30 Milliohms Max.
 Insulation Resistance:1000 Megohms Min.
 Temperature Range:-55°C~+85°C
 Mating Force:35N Max.
 Withdrawal Force:10N Min.
 Durability:1500 Cycles Min.
 Contacts:Brass
△ Insulator/Back Cup:PBT+G.F.(UL94V-0)
 Shell:Brass,Nickel Plated Over All
 RoHS Compliant



CATEGORY USB Connector		APPROVED BY	
PART No. 2137-A-FST2.0		CHECKED BY	
DRAWING No.		DRAWING BY	
SCALE	NONE	REV.	B3

UNLESS OTHERWISE SPECIFIED TOLERANCES ARE

.X ±0.38	.X* ±2*
.XX ±0.25	.XX* ±1*
.XXX ±0.13	.XXX* ±0.5*

UNIT mm

NO.	REV.	REVISIONS	CHK	DATE
△ B3		Modify Data	HZF	08/19/2015
△ B2		Modify P/N Code	HZF	08/11/2014
△ B1		Modify Data	HZF	08/01/2011
△ B0		NEW RELEASE	HZF	06/16/2010